

Notes:

1. Maximum Electric Current: 17A
2. Maximum Electric Rating: Up to 2000V
3. Terminal Material: Copper
4. Wire Range: 20 AWG (0.75mm²)

Standard (Metric)

L1: 0.24 (6.0mm)
 D: 0.06 (1.5mm)
 D1: 0.05 (1.2mm)

Tolerances

(Unless Otherwise Specified)

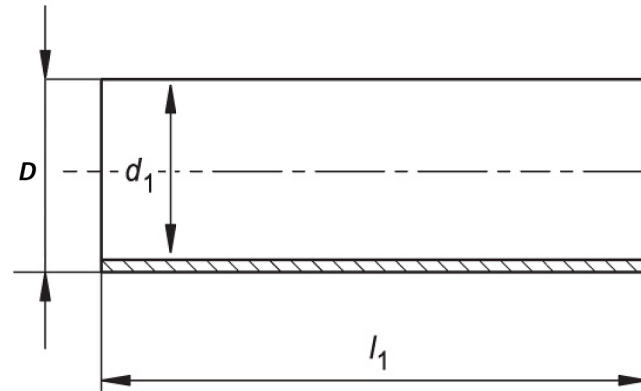

CATEGORY

Non Insulated
Wire Ferrule

SCALE

4/1

PART #

N07506S

SHEET

1-1

MATERIAL

Tin-Plated Copper

PAGE



FerrulesDirect

