

Notes:

1. Cross Section: 4/0 AWG (120mm²)
2. Maximum Electric Current: 360AMP
3. Maximum Electric Rating: 105°C
4. Voltage Rating: 2000V
5. Terminal Material: Copper
6. Terminal Surface Treatment: Tin Plating

Standard (Metric)

L1: 34.0mm (1.33")
D: 17.7mm (0.69")
D1: 16.7mm (0.65")
D2: 19.0mm (0.75")

Tolerances

(Unless Otherwise Specified)

CATEGORY

Non Insulated Wire Ferrules

SCALE

1-1

PART

N1200034

MATERIAL

Tin-Plated Copper

PAGE

10F2



FerrulesDirect

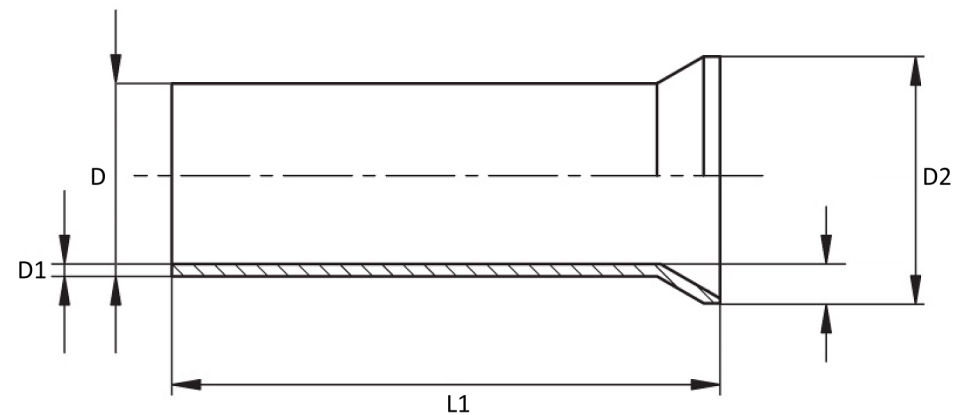

For applicable tools, visit our website: www.FerrulesDirect.com