

Notes:

1. Wire Range: True 4/0 AWG
2. Maximum Electric Current: 360AMP
3. Maximum Electric Rating: 105°C
4. Voltage Rating: 2000V
5. Terminal Material: Copper
6. Terminal Surface Treatment: Tin Plating

Standard (Metric)

L1: 50mm (1.57")
D: 16mm (0.63")
D1: 15mm (0.59")
D2: 17.5mm (0.69")

Tolerances

(Unless Otherwise Specified)

CATEGORY

Non Insulated Wire Ferrules

SCALE

1-1

PART

SF1120050

MATERIAL

Tin-Plated Copper

PAGE

10F2



FerrulesDirect

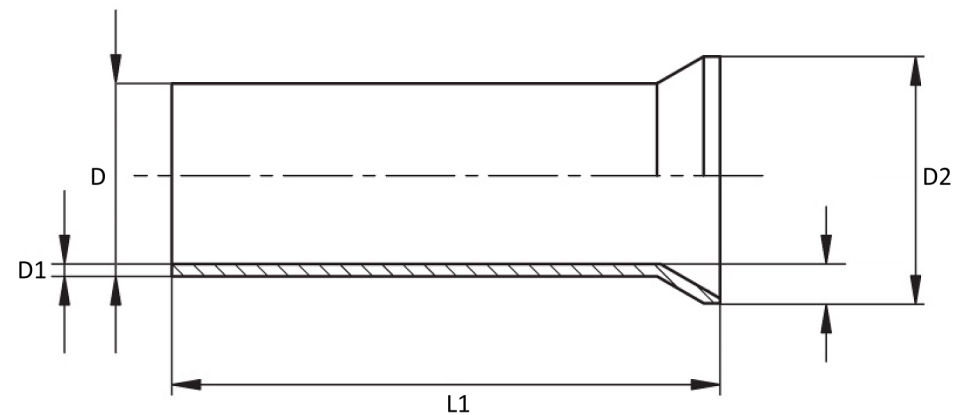

For applicable tools, visit our website: www.FerrulesDirect.com